

ISSUE DATE:

**FEB. 13, 2007**

DECISION/ORDER NO:

**0386**

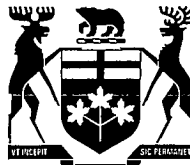

Ontario

Ontario Municipal Board

Commission des affaires municipales de l'Ontario

PL030412

Milton Winberg and Florence Winberg have appealed under subsection 17(36) of the *Planning Act*, R.S.O. 1990, c. P. 13, as amended, from a decision of the Minister of Municipal Affairs and Housing to approve in part, the new Official Plan for the City of Toronto, as adopted by By-law 1082-2002, to provide policy direction in the six municipalities of the former Metropolitan Toronto's

MMAH File No. 20-OP-2002

OMB File No. O030271

**APPEARANCES:**

**Parties**

City of Toronto

Milton and Florence Winberg

**COUNSEL**

R. Andrew Biggart

Bruce H. Engell

**MEMORANDUM OF ORAL DECISION DELIVERED BY R. A. BECCAREA  
ON FEBRUARY 5, 2007 AND ORDER OF THE BOARD**

The Board was advised by the City that the appeal of Milton and Florence Winberg had been settled at the commencement of its hearing.

The Board Orders that the Official Plan for the City of Toronto be modified in accordance with Exhibit "C" to the Affidavit of Gerry Rogalski, marked as Exhibit 1 to this proceeding.

"R. A. Beccarea"

R. A. BECCAREA  
MEMBER

**EXHIBIT "C"**

This is Exhibit "C" referred to in the affidavit of GERRY ROGALSKI sworn before me this 1<sup>ST</sup> day of FEBRUARY, 2007

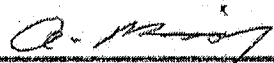
  
A Commissioner, etc.

The Official Plan of the City of Toronto is modified as follows:

1. Schedule 1 is modified by deleting the following rights-of-way that are associated with Park Lane Circle, Post Road and the section of Lawrence Avenue East located between Blaine Drive and Leslie Street:

STREET NAME	FROM	TO	PLANNED RIGHT-OF-WAY WIDTH
a. Lawrence Ave E	Blaine Dr	Leslie St	30
b. Park Lane Crcl	Post Rd	Lawrence Ave E	23
c. Post Rd	Bayview Ave	The Bridle Path	27

2. Schedule 1 is modified by deleting the number "27" and replacing it with the number "23" under "Planned Right-of-Way Width" for the two right-of-way sections that are associated with Lawrence Avenue East and located between Park Lane Circle and 120 metres east of The Bridle Path, so that the relevant portion of Schedule 1 now reads as follows:

STREET NAME	FROM	TO	PLANNED RIGHT-OF-WAY WIDTH
a. Lawrence Ave E	The Bridle Path	Park Lane Crcl	23
b. Lawrence Ave E	The Bridle Path	120 m east of The Bridle Path	23

3. Chapter 7, Site and Area Specific Policies, is modified by adding a Site and Area Specific Policy for the rights-of-way in Schedule 1 that are associated with the sections of Lawrence Avenue East located between Park Lane Circle and 120 metres east of The Bridle Path, as follows:

**"278. Lawrence Ave. East Right-of-Way between The Bridle Path and Park Lane Circle, and Lawrence Ave. East Right-of-Way between The Bridle Path and 120 m east of The Bridle Path**

Additional lands acquired to achieve the right-of-way widths shown in Schedule 1 will be utilized for boulevards, the placement of utilities, landscaping and pedestrian amenities, but not for additional lanes of motor vehicle traffic or bicycle lanes.

... continued

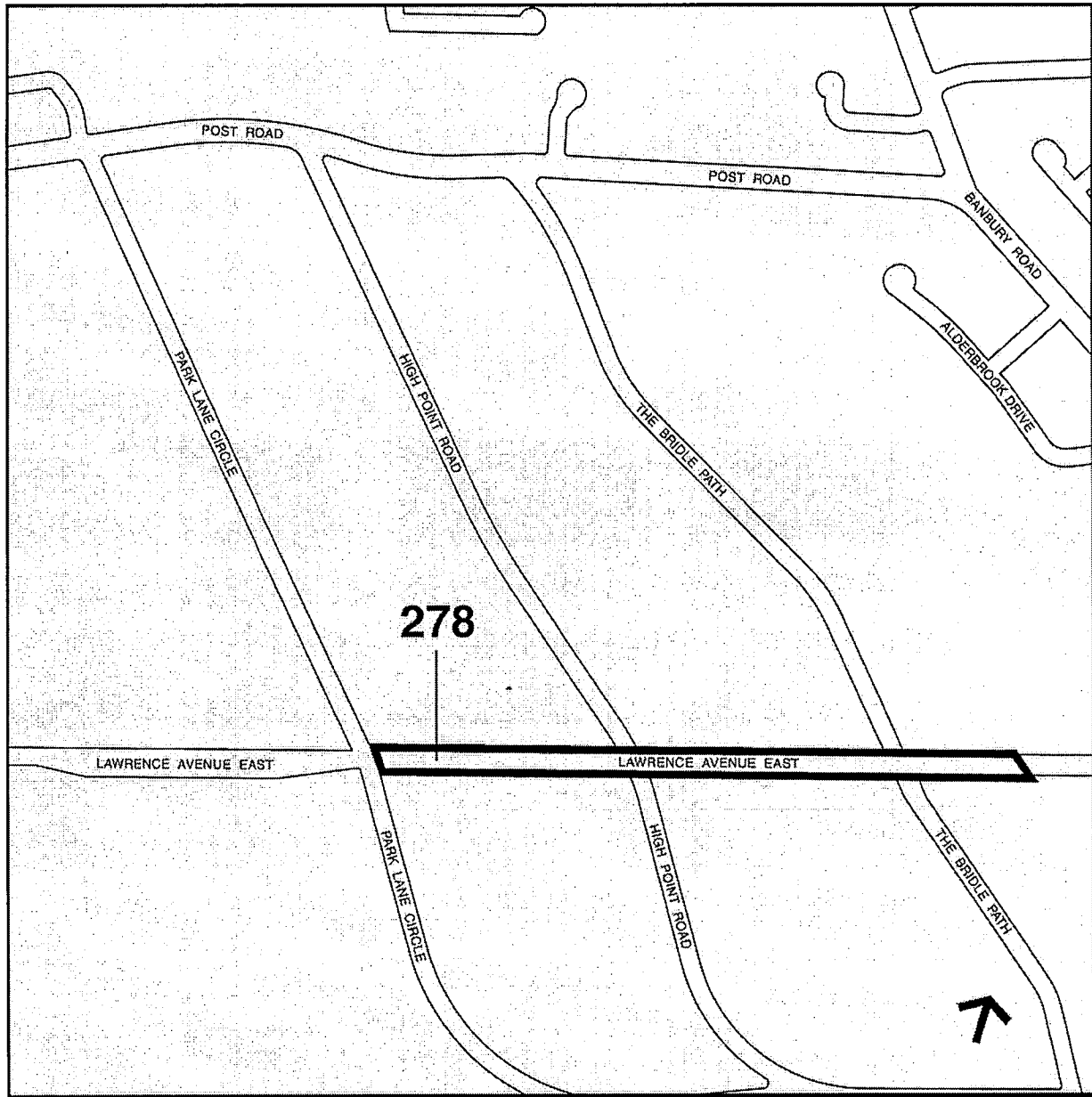

33

1. Maps 27, 28, 30 and 31, Site and Area Specific Policies, are modified by adding the rights-of-way in Schedule 1 that are associated with the two sections of Lawrence Avenue East located between Park Lane Circle and 120 metres east of The Bridle Path, as shown on the map above forming part of Site and Area Specific Policy No. 278.

EXHIBIT "D"

This is Exhibit "D" referred to in the affidavit of GABRIEL ROGALSKI sworn before me this 1<sup>st</sup> day of FEBRUARY, 2007

[Signature]  
A Commissioner, etc.

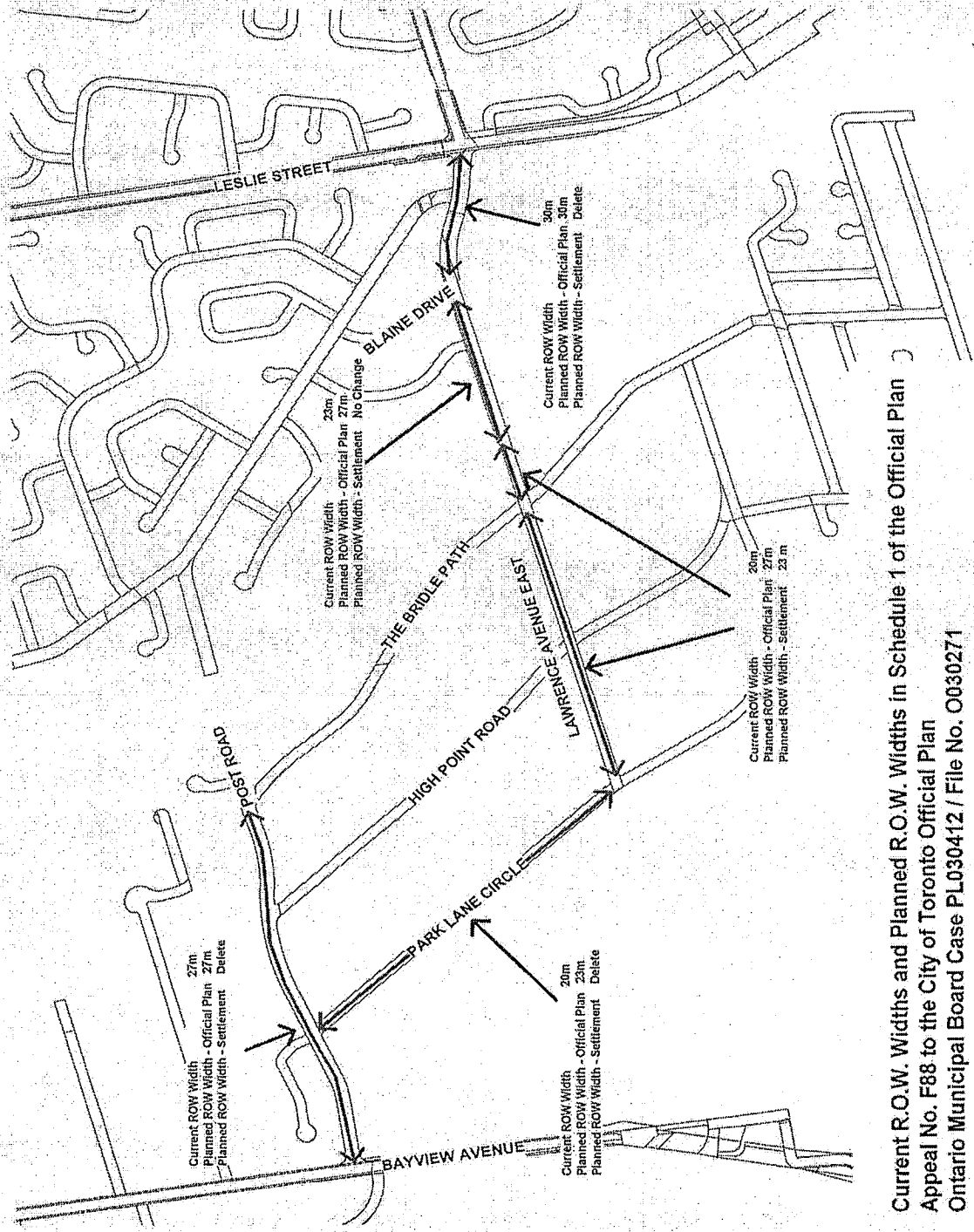

Current R.O.W. Widths and Planned R.O.W. Widths in Schedule 1 of the Official Plan  
Appeal No. F88 to the City of Toronto Official Plan  
Ontario Municipal Board Case PL030412 / File No. 0030271